

# TI-440 Wifi Setup

## Step 1



Factory reset button on the bottom of the camera.

Power up camera.

Camera will start rotating and green light start blinking.

Camera is in pairing mode.

Press and hold reset button if camera light is not blinking.

## Step 2

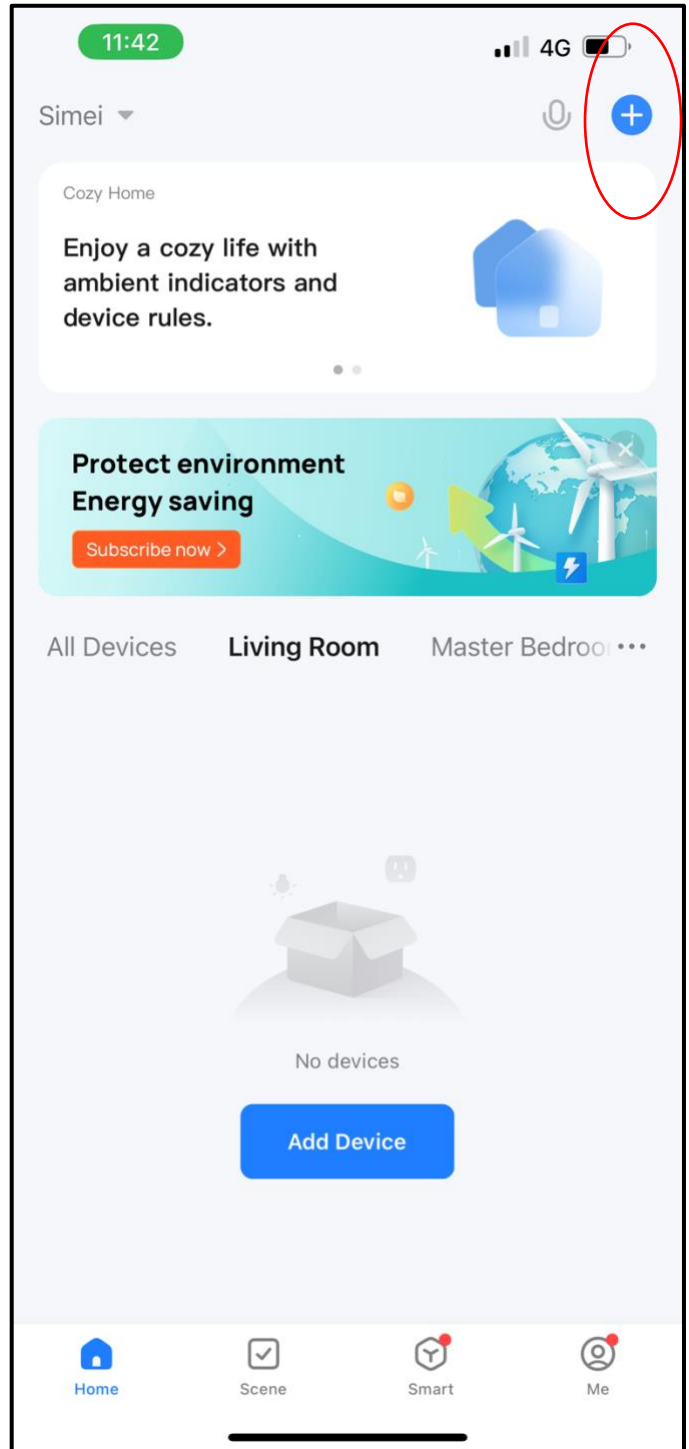

Tap the top right + to add device.

### Step 3

### Step 4

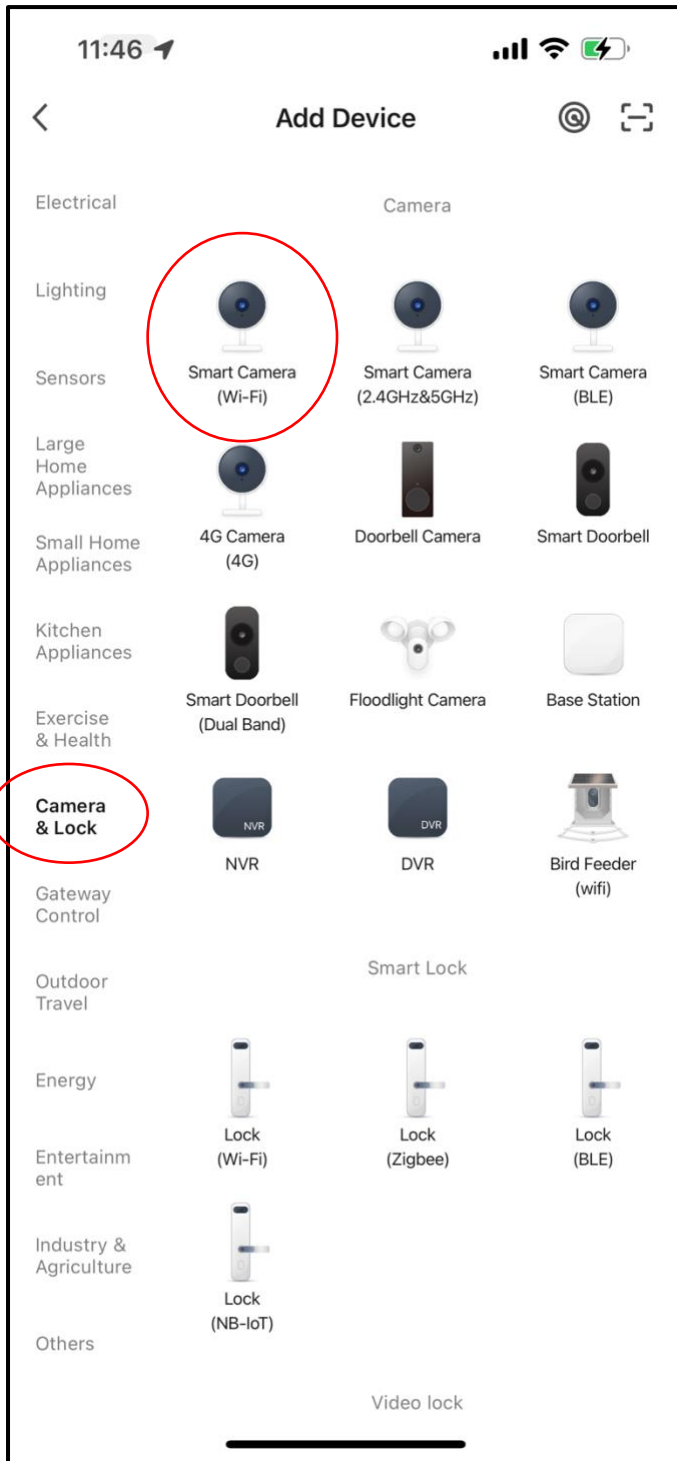

Select the correct device.

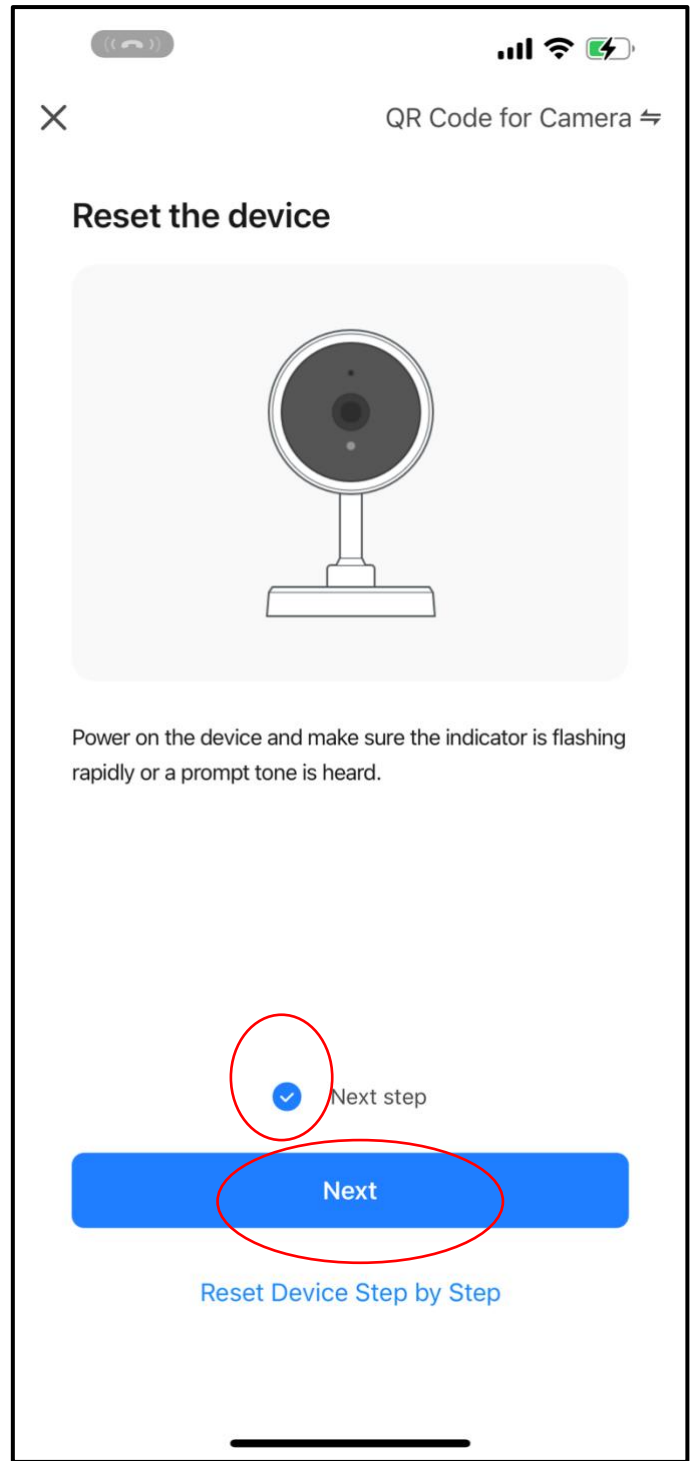

Check the box

Click "Next" to continue

## Step 5

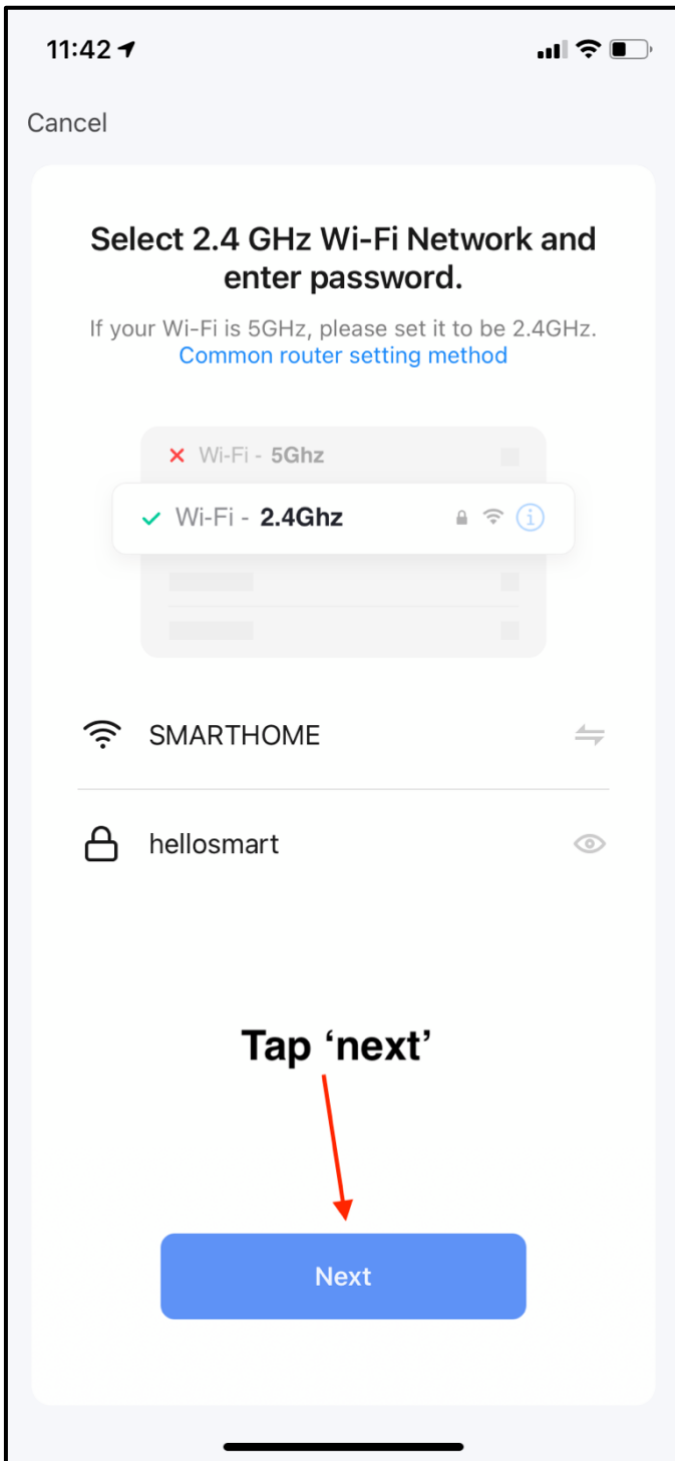

Choose 2.4G network and key in the correct password.

## Step 6

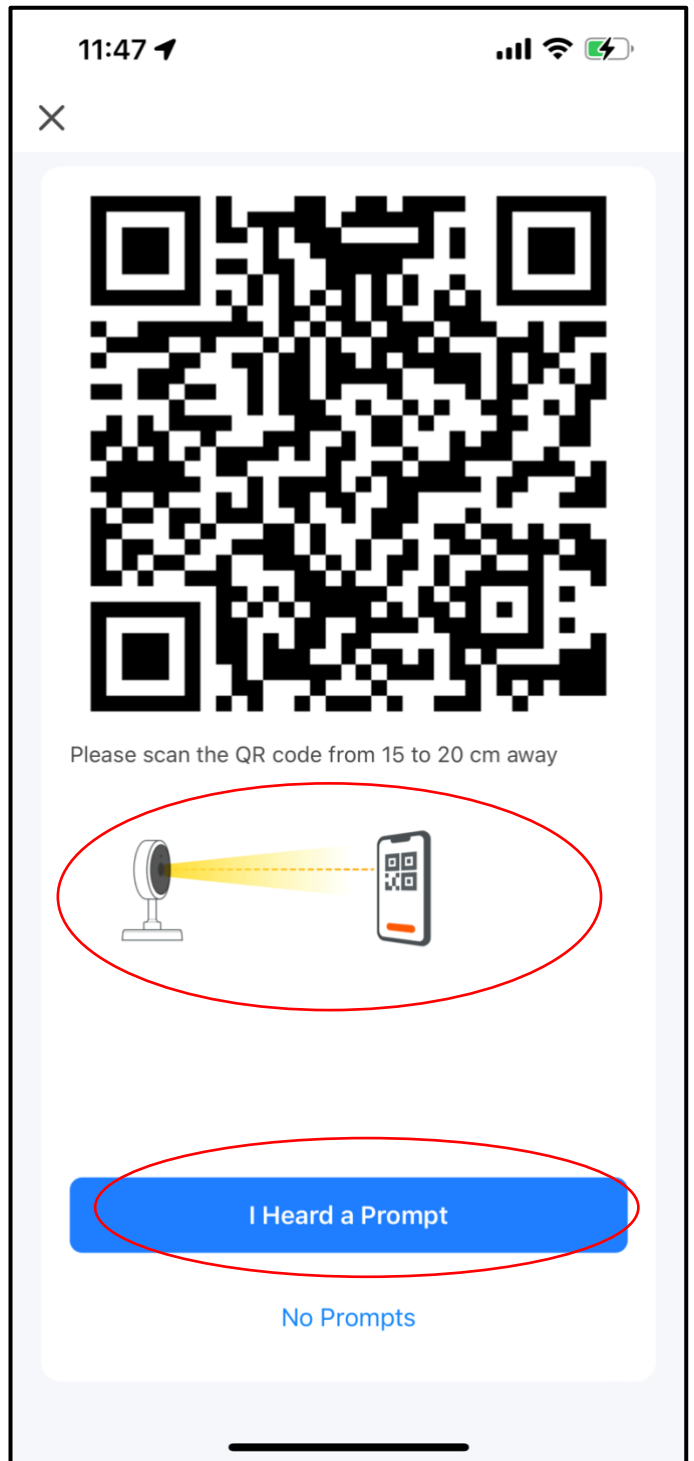

Scan the QR code on the app to the doorbell lens. Distance should be 15-20cm away.

After successful detection, tap "I Heard a Prompt"

## Step 7

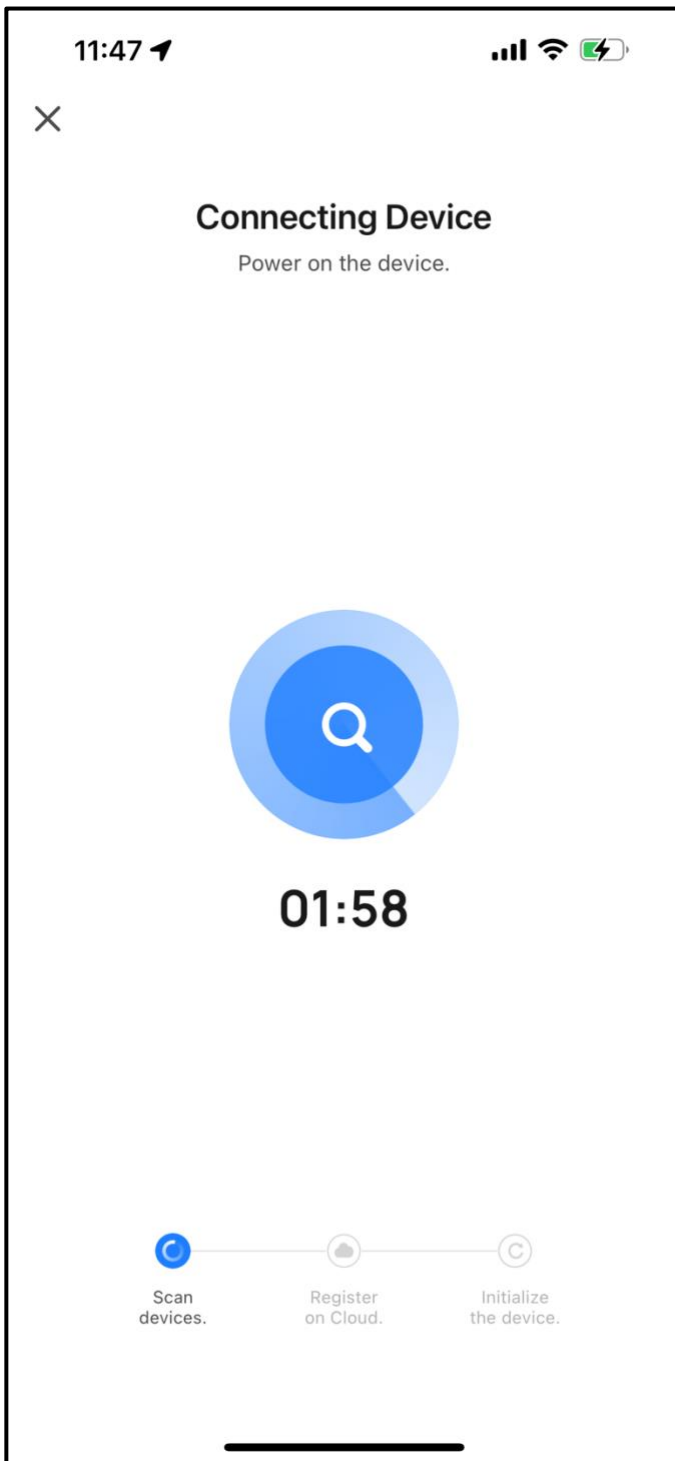

If pairing is not successful,  
repeat Step 1 again.

The camera pairing process  
will begin.